

Cu cable lugs

PK series

Technical information

SSTL code	Conductor/hole (mm ² /mm)	L (mm)	L1 (mm) +-1	d1 (mm)	d2 (mm)	b (mm)	Package (pcs/bag or box)
5201102	0.75-4	17	13,5	1,3	3	6,5	100
5201105	1.5-3	16	13	1,9	3,4	6,5	100
5201106	1.5-4	17	13,5	1,9	3,4	6,5	100
5201107	1.5-5	18	13,5	1,9	3,4	7,5	100
5201110	2.5-3	16	13	2,6	4,2	6,5	100
5201111	2.5-4	17	13,5	2,6	4,2	6,5	100
5201112	2.5-5	18	13,5	2,6	4,2	7,5	100
5201113	2.5-6	21	15,5	2,6	4,2	8,5	100
5201120	6-4	23	17,5	3,6	6	8,5	100
5201121	6-5	23	17,5	3,6	6	9,5	100
5201122	6-6	25	17,5	3,6	6	9,5	100
5201123	6-8	30	23	3,6	6	13	100
5201125	10-5	32	22	5	8	11,5	100
5201126	10-6	32	22	5	8	11,5	100
5201127	10-8	34	22	5	8	13,5	100
5201128	10-10	40	27	5	8	14	100
5200300	16-5	34	27	6	9	13	100
5201130	16-6	34	26	6	9	13	100
5201131	16-8	34	26	6	9	13	100
5201132	16-10	40	29	6	9	16	100
5201133	16-12	43,5	31,5	6	9	18	100
5200301	16-14	43,5	31,5	6	9	18	100
5201135	25-6	37	30	8	11	16	100
5201136	25-8	37	30	8	11	17	100
5201137	25-10	40	33	8	11	17	100
5201138	25-12	46	34	8	11	20	100
5200302	25-14	46	34	8	11	20	100
5201139	25-16	54	39,5	8	11	23	100
5201140	35-6	44	35	9	13	18,5	100
5201141	35-8	44	35	9	13	18,5	100
5201142	35-10	44	35	9	13	18,5	100
5201143	35-12	48,5	36,5	9	13	20	100
5201743	35-14	48,5	36,5	9	13	20	100
5201144	35-16	56	41,5	9	13	23	100
5200303	50-6	49	40	11	14,5	21	100
5201145	50-8	49	40	11	14,5	21	100
5201146	50-10	49	40	11	14,5	21	100
5201147	50-12	55	43	11	14,5	23	100
5201747	50-14	55	43	11	14,5	23	100
5201148	50-16	60,5	46	11	14,5	24	100

The **Cu cable lug** is designed for connecting Cu cables and for the terminating, connecting and branching of coils, cables and busbars. The connectors are suitable for connecting both finestranded and few-stranded cables.

The cables conform to the SEN norm, standard SFS 2663 and the T2 thermal class. The Cu connectors are also compatible with PEX cables. The crimping-type terminals are manufactured from high-conductivity copper and the most common surface treatment is tin. Installation work requires only the most basic crimping tools.

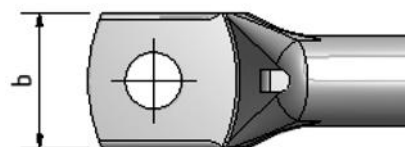
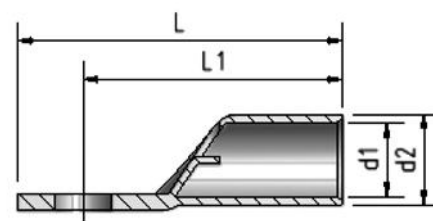
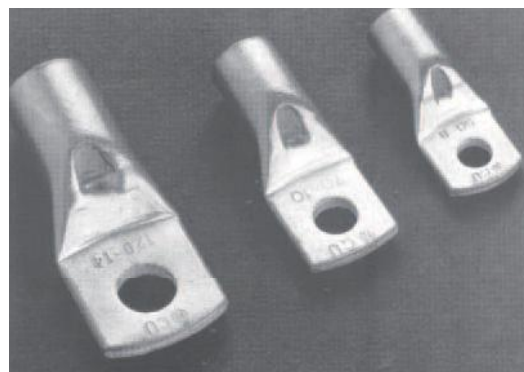

Cu cable lugs

PK series

Technical information

SSTL code	Conductor/hole (mm ² / mm)	L (mm)	L1 (mm) +-1	d1 (mm)	d2 (mm)	b (mm)	Package (pcs/bag or box)
	70-6	58	49	13	17	24,5	50
5201150	70-8	58	49	13	17	24,5	50
5201151	70-10	58	47	13	17	24,5	50
5201152	70-12	58	46,5	13	17	24,5	50
5201752	70-14	58	46,5	13	17	24,5	50
5201153	70-16	65	50,5	13	17	28	50
5201155	95-10	69	55	15	20	29	50
5201156	95-12	69	55	15	20	29	50
5201756	95-14	69	55	15	20	29	50
5201157	95-16	69	55	15	20	29	50
5201160	120-10	72	58	17	22	32	25
5201161	120-12	72	58	17	22	32	25
5201761	120-14	72	58	17	22	32	25
5201162	120-16	72	58	17	22	32	25
5201164	150-10	81	65	19	25	36	25
5201165	150-12	81	65	19	25	36	25
5200304	150-14	81	65	19	25	36	25
5201166	150-16	81	65	19	25	36	25
5201167	150-20	81	65	19	25	36	25
5200305	185-10	89	71	21	27	39	20
5201170	185-12	89	71	21	27	39	20
5200306	185-14	89	71	21	27	39	20
5201171	185-16	89	71	21	27	39	20
5201172	185-20	89	71	21	27	39	20
5200307	240-10	99	81	24	30	44	10
5201175	240-12	99	81	24	30	44	10
5200308	240-14	99	81	24	30	44	10
5201176	240-16	99	81	24	30	44	10
5201177	240-20	99	81	24	30	44	10
5200309	300-10	114	91	26	32	48	10
5200310	300-12	114	91	26	32	48	10
5201178	300-14	114	91	26	32	48	
5201179	300-16	114	91	26	32	48	10
5201180	300-20	114	91	26	32	48	10
5201181	300-24	114	91	26	32	48	
5201184	400-16	126	103	30	36	48	
5201185	400-20	126	103	30	36	48	
5201186	400-24	126	103	30	36	48	
5200311	500-20	134	111	33	42	48	
5200312	500-24	134	111	33	42	48	

Cu butt sleeves and parallel sleeves

Technical information | Parallel sleeve

SSTL code	Conductor (mm ²)	L (mm) ±1	d1 (mm)	d2 (mm)	Package (pcs/bag or box)
5206705	1.5	7	1,9	3,4	100
5206710	2.5	7	2,6	4,2	100
5206720	6	9	3,6	6	100
5206725	10	10	5	8	100
5206730	16	14	6	9	100
5206735	25	14	8	11	100
5206740	35	14	9	13	100
5206745	50	18	11	14,5	50
5206750	70	18	13	17	50
5206755	95	20	15	20	50
5206760	120	22	17	22	50
5206765	150	26	19	25	25
5206770	185	28	21	27	25
5206775	240	30	24	30	25
5206780	300	35	26	32	10

Butt sleeves and parallel sleeves are designed for the branching and extending of Cu conductors, Cu cables and coils. The butt sleeves conform to the SEN-norm, standard SFS 2663 and the T2 thermal class. Ouneva's butt sleeves are also compatible with PEX cables. The connectors are manufactured from high-conductivity copper and are electrolytically tin-plated. Installation work requires only the most basic crimping tools.



Technical information | Cu butt sleeve

SSTL code	Conductor (mm ²)	L (mm) ±1	d1 (mm)	d2 (mm)	Package (pcs/bag or box)
5206600	0.75	14	1,3	3	100
5206605	1.5	14	1,9	3,4	100
5206610	2.5	16	2,6	4,2	100
5206620	6	19	3,6	6	100
5206625	10	21	5	8	100
5206630	16	29	6	9	100
5206635	25	35	8	11	100
5206640	35	35	9	13	100
5206645	50	40	11	14,5	50
5206650	70	40	13	17	50
5206655	95	55	15	20	50
5206660	120	55	17	22	50
5206665	150	55	19	25	25
5206670	185	70	21	27	25
5206675	240	70	24	30	25
5206680	300	75	26	32	10
5206685	400	75	30	36	10

